

HAVELOCK
Ferndale



Stay Connected to Happiness...



HAVELOCK HOMES

Built on Relationships

BUILDERS & DEVELOPERS



HAVELOCK

Ferndale



HAVELOCK Ferndale

Havelock Homes proudly presents an impressive legacy of 2 decades in realty amalgamated with design excellence to create an architectural masterpiece – The HavelockFerndale in the heart of Bengaluru. A premier downtown address in a vibrant neighbourhood, modern amenities and aesthetic sensibilities all in strategic proximity to business, shopping and medical centres, elevates living at Havelock Ferndale to hitherto unexplored heights of Luxury, Comfort and Sophistication!

Meticulous planning, thoughtful choice of furnishings and emphasis on comfort make Havelock Ferndale an abode befitting the choices and preferences of the discerning urbanite. Being affordable, it is within an easy distance of the International Airport, Hebbal Ring Road, Lumbini Gardens and some of the best educational institutions, making it a prudent choice and the culmination of many dreams!

HAVELOCK Ferndale

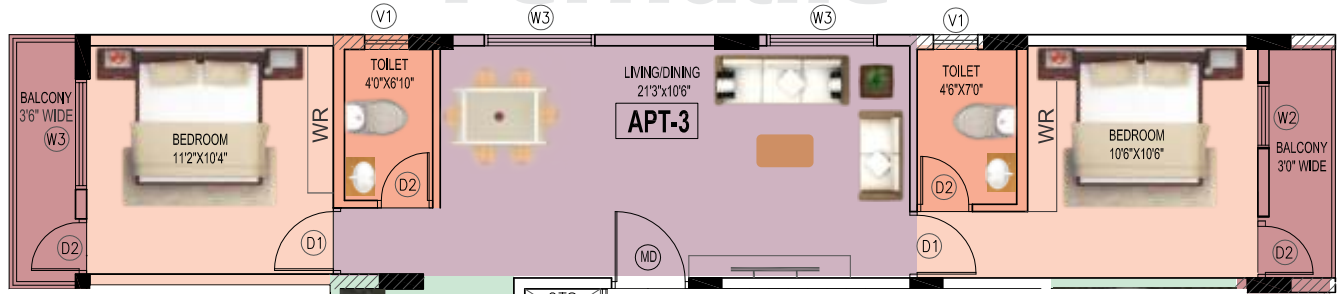

WEST FACE

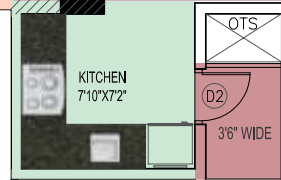

EAST FACE

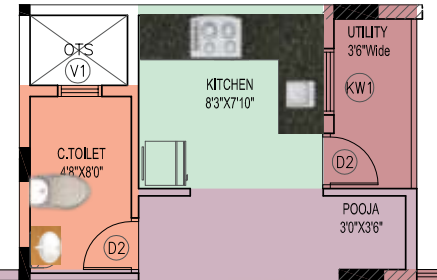

EAST FACE

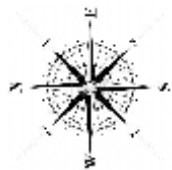
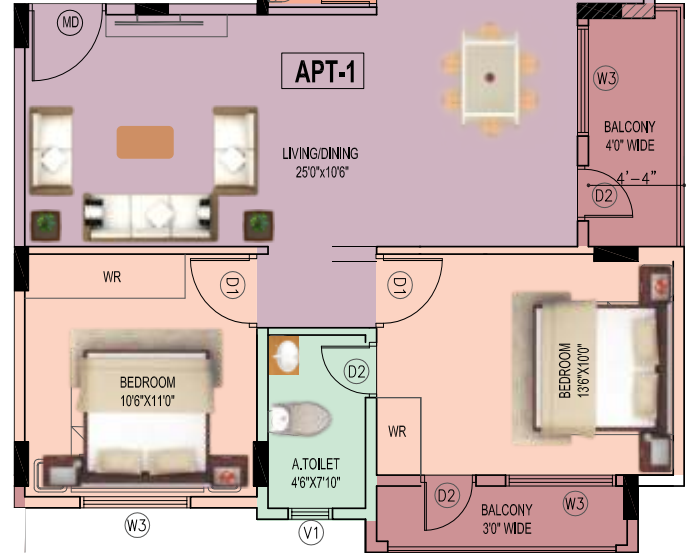

MASTER PLAN

APT.NO	TYPE	Super Built up Area
01	2bhk	1087 Sq ft
02	2bhk	1023 Sq ft
03	2bhk	925 Sq ft

SPECIFICATIONS:

- **STRUCTURE:**
RCC Framed structure, Solid brick Masonry, plastering with smooth finishing.
- **WALLS:**
External walls of 6" solid block,
Internal walls with 4" solid blocks.
- **PLASTERING:**
External walls - Smooth sponge finish,
Internal walls - Lime rendering with Birla putty 2 Coat.
- **DOORS:**
Main doors: Teak wood frame with Teakwood Shutters
Internal doors: Sal wood Frame with Solid Primer shutter.
- **WINDOWS:**
Three track aluminum powder coated windows and mosquito mesh with MS safety grill
- **FLOORING:**
Branded vitrified flooring for living, dining, kitchen, bedrooms and
Anti-skid ceramic tiles for balconies and bathroom flooring.
- **TOILET:**
Anti skid ceramic flooring and glazed tiled dado up to 7 height,
CP fittings and Sanitary Fittings Hindware or Equivalent ISI fittings.
- **ELECTRICAL:**
Copper wiring of Anchor / Equivalent.
Switches of Anchor / equivalent Switches and Sockets.
TV and Telephone point in living and Master Bedroom.
AC point in Master Bedroom.
- **PAINTING:**
Asian or equivalent, Emulsion paint for interiors,
Water - proof emulsion paint for exteriors.
- **COMMON AREA:**
Granite flooring
- **LOBBY & LIFTS:**
Entrance lobby finished with Granite flooring
One Lift of 6 passengers capacity with standard make.
- **WATER SUPPLY**
Water supply from Borewell & Kaveri.
- **CAR PARKING:**
Covered car parking.



AMENITIES :

- Party Hall
- Round the clock security
- One Lift of 6 passengers
- Rain Water Harvesting

HIGHLIGHTS:

- BBMP approved
- Excellent Landmark
- As per Vaastu
- Optimum space utilization
- Near Manyatha Tech Park & Ring Road
- Near Lumbini Garden
- Near Schools & Hospitals
- Near Element Mall & Esteem Mall

LOCATION MAP

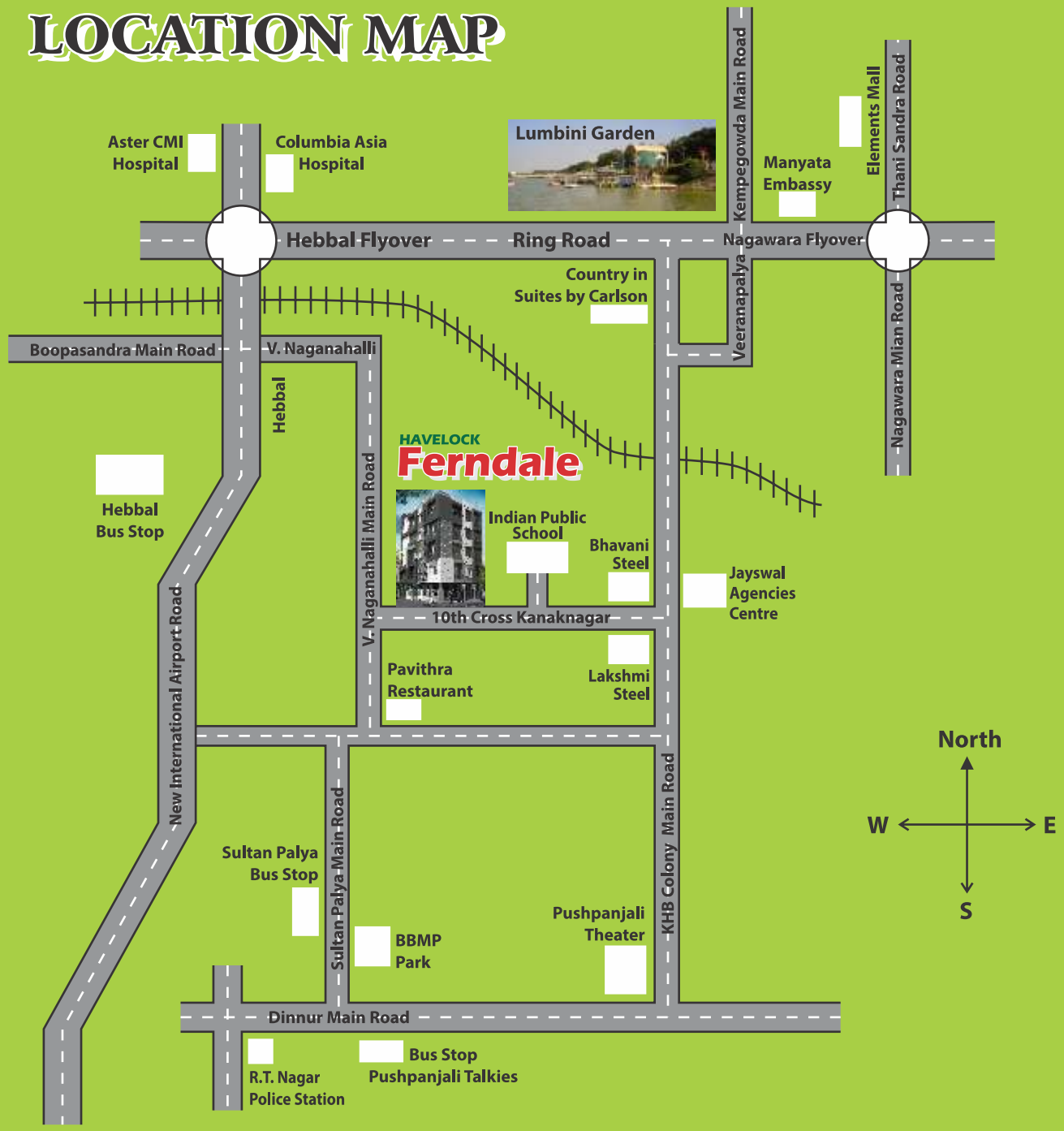



HAVELOCK HOMES

Built on Relationships

BUILDERS & DEVELOPERS

No.55, 10th Cross, Kanaka Nagara,
R.T. Nagar Post, Bangalore-560 032. Tel : 9880173004

E-mail : info@havelockhomes.in

Web : www.havelockhomes.in

Site Address :

HAVELOCK
Ferndale

No.55, 10th Cross,
Near Indian Public School,
Kanaka Nagara, R.T. Nagar Post,
Bangalore-560 032.

Architects :

DESIGN MATRIX

#916, 16th Cross, 1st stage,
1st Phase, Chandra Layout,
Bangalore - 560 072.

Mob : 9845449838, 9845596169

Email : designmatrix.blr@gmail.com